

Design Shoichi Uchiyama

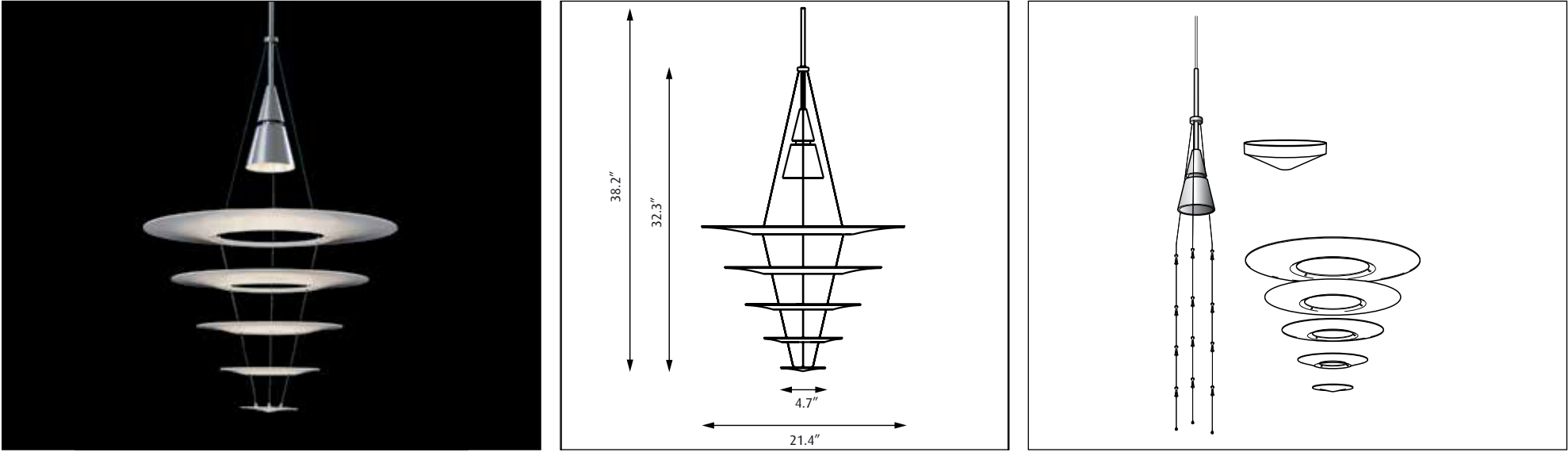

Light source	Voltage	Weight	Electric shock protection	Ingress protection
Max 1/50W/PAR16/GU10	Max 120 V	4.2 Lbs	Dry location	IP 20

Recommended cleaning substances:
Wipe off dust with a dry, soft cloth. Remove greasy spots etc. with a soft cloth dampened in lukewarm water (<122° F/ 50° C) with a mild detergent.
Never use detergents containing abrasives and solvents.

Warning: Scouring powder and similar substances will scratch surfaces.

All installation is subject to local code and jurisdiction. Consult a qualified electrician to ensure correct branch circuit conductor.
The installer must ensure that the ceiling can support the luminaire's weight. The installer must if necessary reinforce the ceiling structure by adequate means.

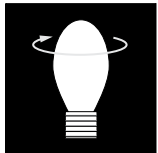

See further mounting instructions in the manual supplied with the canopy

The installer must ensure to use proper means (rawplugs / screws / expansion bolts) to secure the fixture to the ceiling material. (Means not provided)
The installer must if necessary reinforce the ceiling structure by adequate means.

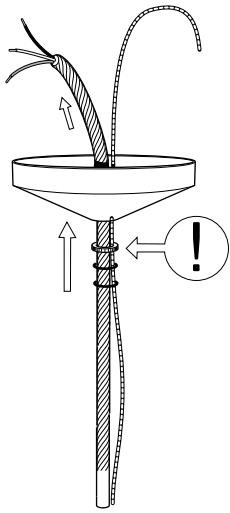

ID NUMBER: _____

Please register ID number at www.louispoulsen.com

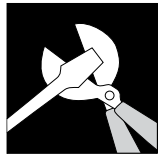
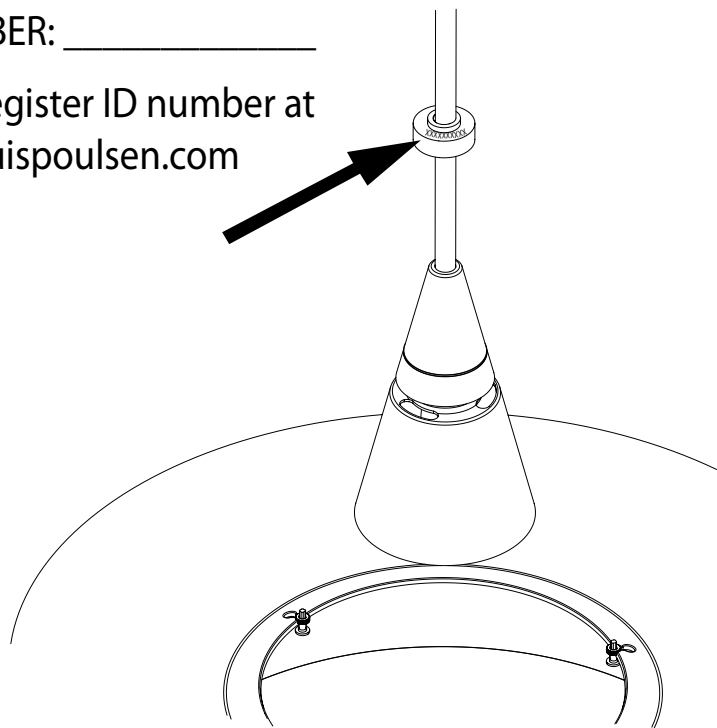

1

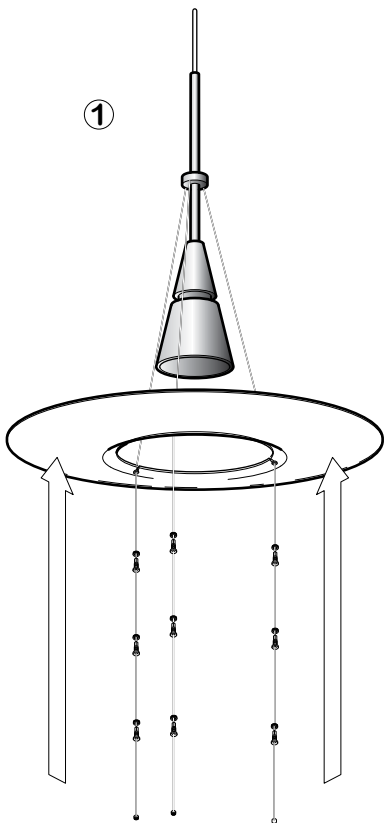

2

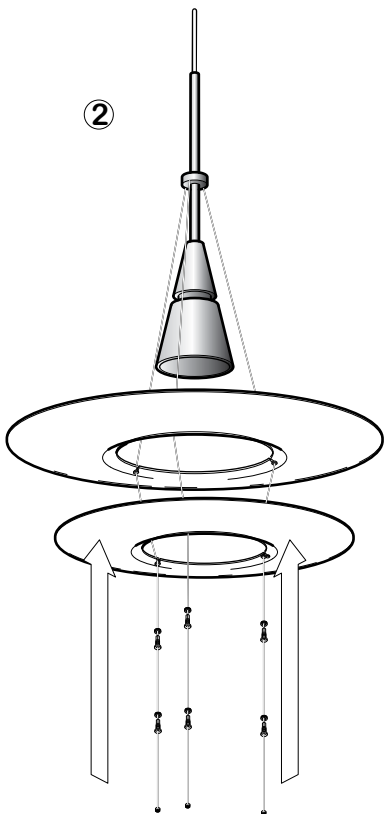

3

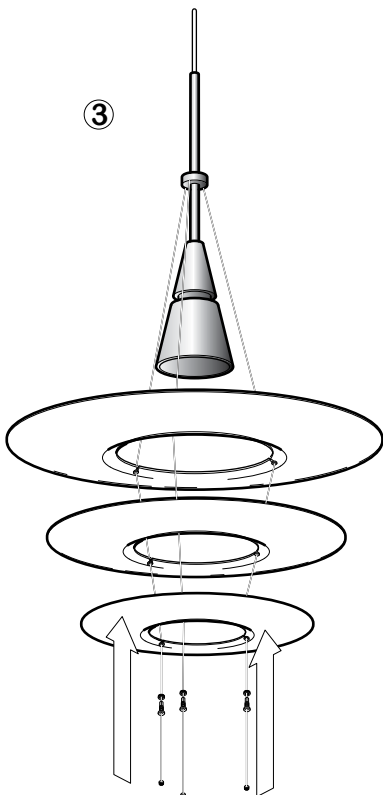

4

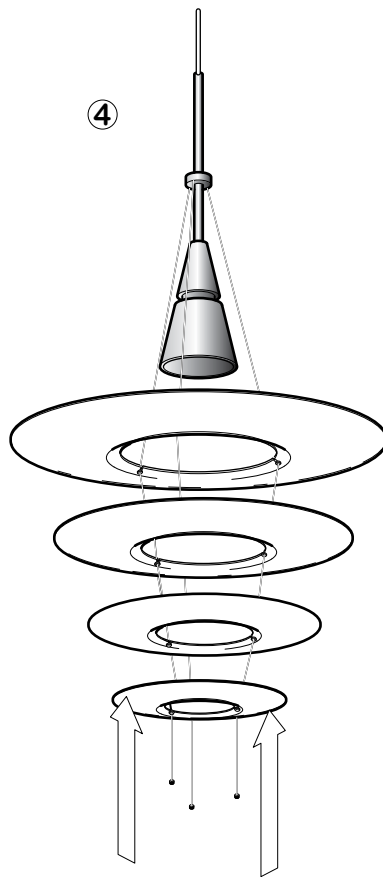

5

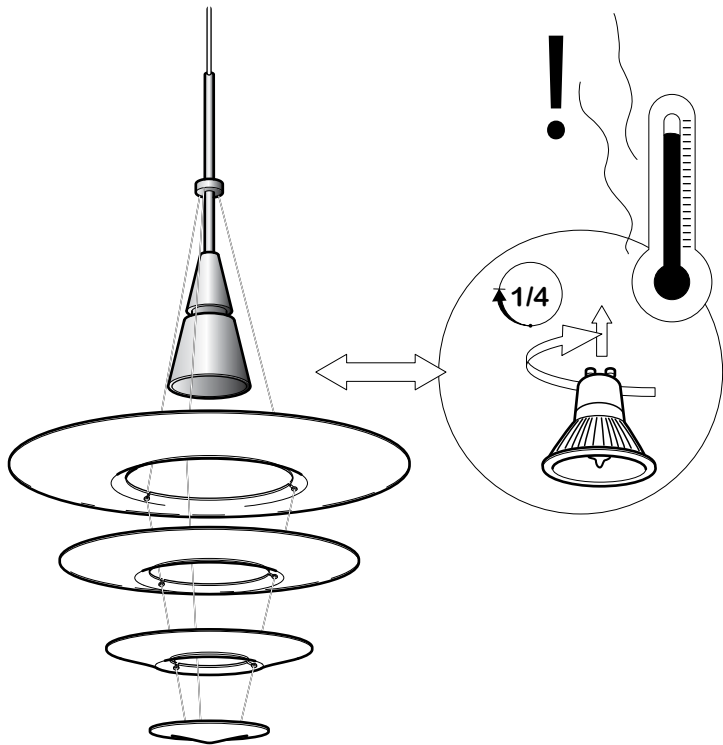
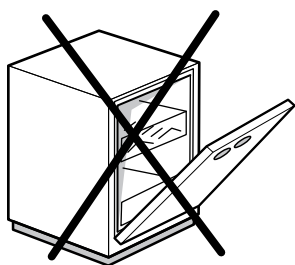
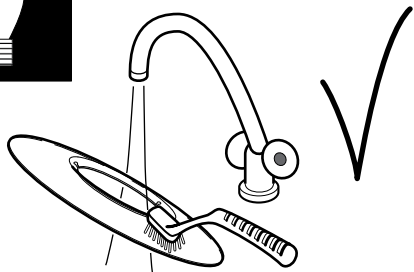
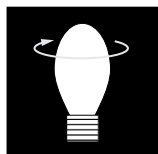
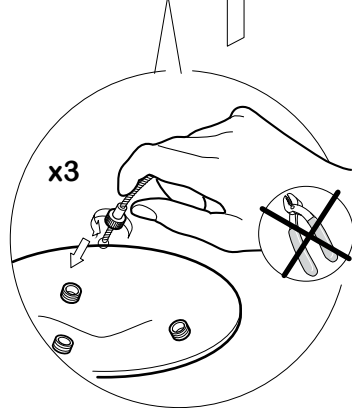
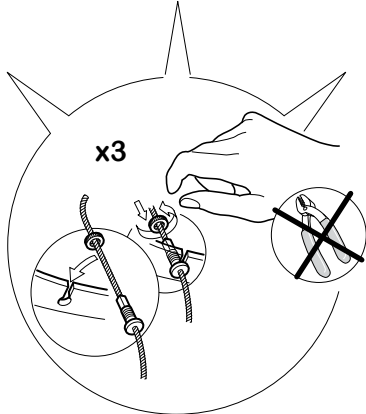
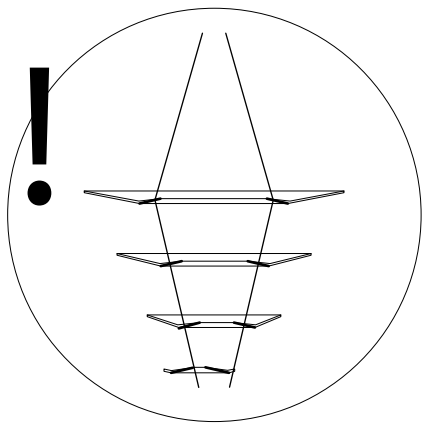
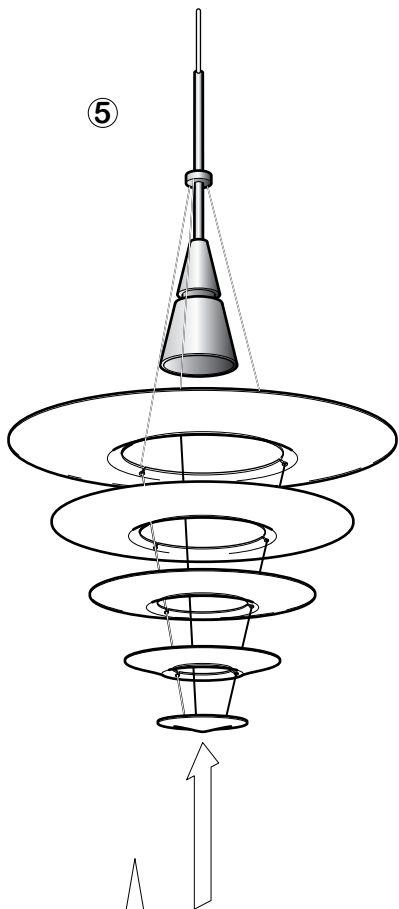

1/4

GU10
120V

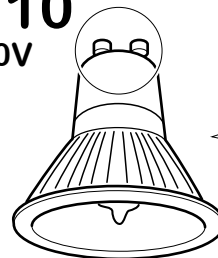

"Q-PAR"
"TWISTLINE"
"HALOPAR16"
"MR16"

